



Longer Equipment & Fluid Life - Lower Maintenance Costs

Magnom® IPU In-line Process Units

Designed for heavy duty industrial applications these large Magnom units have a high contaminant holding capacity (up to 4000g) making them the ideal choice for applications and environments with high contaminant levels.



Mounting Method:	In-Line
Flow Direction:	Bi-Directional
Construction Material:	
Housing	Aluminium Alloy
Magnet	Ceramic Ferrite
Mandrel	Aluminium Alloy
Magnom Plates	Carbon Steel
C-Clip	Steel
O-Ring	Viton
Max. Operating Temperature: °C/(°F)	120/248
Max. Operating Pressure: BAR/(PSI)	17/246
Burst Pressure: BAR/(PSI)	50/725

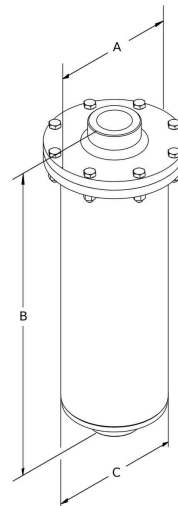

UNIT WEIGHT AND DIMENSIONAL INFORMATION						
Part Number	Unit	Connection / Size	Weight KG / (OZ)	DIM.A CM / (Inch)	DIM.B CM / (Inch)	DIM.C CM / (Inch)
520102100	5	2" BSP	8.2 / (288)	20 / (8)	23.5 / (9.25)	15 / (6)
520102200	20	2" BSP	25 / (880)	20 / (8)	52.2 / (20.5)	15 / (6)
520103100	5	2" NPT	8.2 / (288)	20 / (8)	23.5 / (9.25)	15 / (6)
520103200	20	2" NPT	25 / (880)	20 / (8)	52.2 / (20.5)	15 / (6)

Product Data Sheet : In-line Process Units

www.magnom.com

info@magnom.com

UK Office: tel +44 (0) 1926 623170 fax +44 (0) 1926 623171

USA Office: tel (312) 738 1147 fax (312) 893 2096